



JOB NAME:	CONTRACTOR:
JOB LOCATION:	APPROVAL:
ENGINEER:	CONTRACTOR P.O.:
APPROVAL:	REPRESENTATIVE:

EXM8E0740H-00* - EXM8E0741H-00* - EXM8E0742H-00*
FNPT THREADED SOCKET WELD BUTT WELD

740LL FULL PORT, HIGH PRESSURE DIRECT MOUNT 2-WAY, 3-PIECE STAINLESS STEEL WITH ENCAPSULATED BOLTS BALL VALVE IN NPT, SW OR BUTT WELD W/ CSA APPROVED EXPLOSION-PROOF METAL ACTUATOR

SIZES 1/4" TO 1"

*002 24 AC/DC ON/OFF	*003 110V DC ON/OFF	*004 220V DC ON/OFF
*022 POSITIONER	*023 POSITIONER	*024 POSITIONER

SPECIFICATIONS

The EXM8E0740H/EXM8E0741H/EXM8E742H series packages feature a stainless steel high performance three-piece full port, encapsulated bolt style, to 3600 psi ball valves. The valve also incorporates an ISO 5211 direct mount pad with square stem. Further, the valve has high temperature PEEK seats, conforms to ANSI 16.34, ANSI B1.20.1 Thread depths, and NACE MRO 175. The heavy duty industrial EXM series electric actuator features a direct mount CSA certified NEMA 4X,7,8, and 9 housing, with 2 auxiliary switches, 1/2" conduit connections, built in thermal overload protection, heater & thermostat, clutch-less manual override, and a temperature range of -22°F to 156°F.

ACTUATOR FEATURES

- NEMA 4x, 7, 8 & 9 (CSA Approved)
- Enclosure conforms to IP68 with explosion-protected performance and 1/2" FNPT conduit connection
- Temperature range: -22°F to 158°F
- Clutch-less Manual Override
- Thermostatically controlled anti-condensation heater for working conditions
- Available in both ON/OFF (-00*) or 4~20 mA MODULATING (-02*)
- 30% Duty Cycle (ON/OFF) and 75% Duty Cycle (MODULATING)
- Continuous mechanical position indicator.
- Built-in thermal overload protection prevents motor burnout

VALVE FEATURES

- Sizes 1/4" to 1"
- High pressure to 3600 psi
- High temperature to 500°F max
- Direct mounting to ISO 5211/square stem
- PEEK seats
- Standard latch locking handle
- Conforms to ANSI B16.34, ANSI B1.20.1 thread depths, NACE MR0175

PRESSURE - TEMPERATURE CHART FOR SERIES 740H/741H/742H

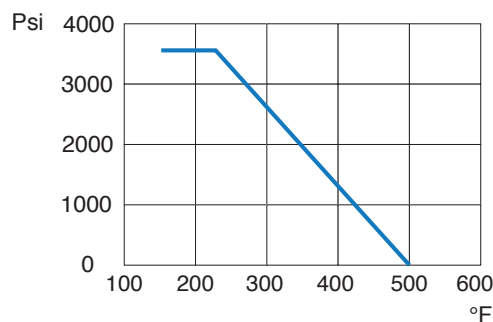

CSA APPROVALS

Class I, Division 1, Groups C, D, T4
 Class II, Division 1, Groups E, F, G T130°C
 Type 4x
 Ex db IIB T4 Gb (For Canada)

Class I, Zone 1, AEx db IIB T4 Gb (For US)
 Ex tb IIIC T130°C Db (For Canada)
 Zone 21, AEx tb IIIC T130°C Db (For US)
 IP68 (72h, 7m)



BILL OF MATERIALS FOR 740H / 741H / 742H

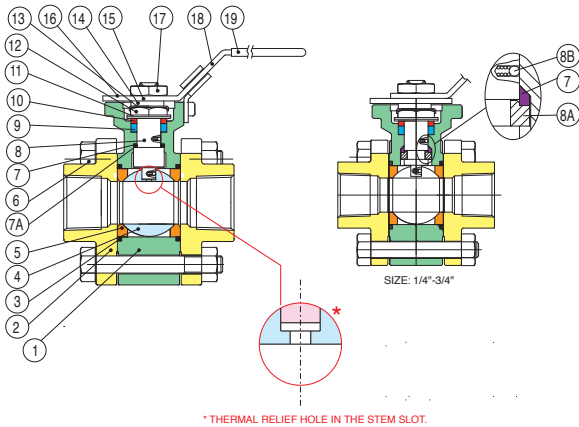

N POS	PART NAME	MATERIAL	N POS
1	BODY	CF8M	1
2	END CAP	CF8M	2
3	GASKET BODY	TFM	2
4	BALL	SS316	1
5	BALL SEATS	PEEK	2
6	BOLTS	SS304	*
7	THRUST WASHER	TFM	1
7A	THRUST WASHER	PEEK	1
8	STEM	SS316	1
8A	HALF SPLIT RING	SS316	1
8B	ANTI-STATIC	SS316	2

N POS	PART NAME	MATERIAL	N POS
9	STEM PACKING	TFM	1
10	GLAND WASHER	SS304	1
11	DISK WASHER	SS301	1
12	STEM NUT	SS304	1
13	NUT STOP	SS304	1
14	SPACE WASHER	SS304	1
15	PLATER	SS304	1
16	STOP IN	SS304	1
17	HANDLE NUT	SS304	1
18	HANDLE	SS304	1
19	HANDLE COVER	PLASTISOL	1

*VARIES WITH SIZE

DIMENSIONS

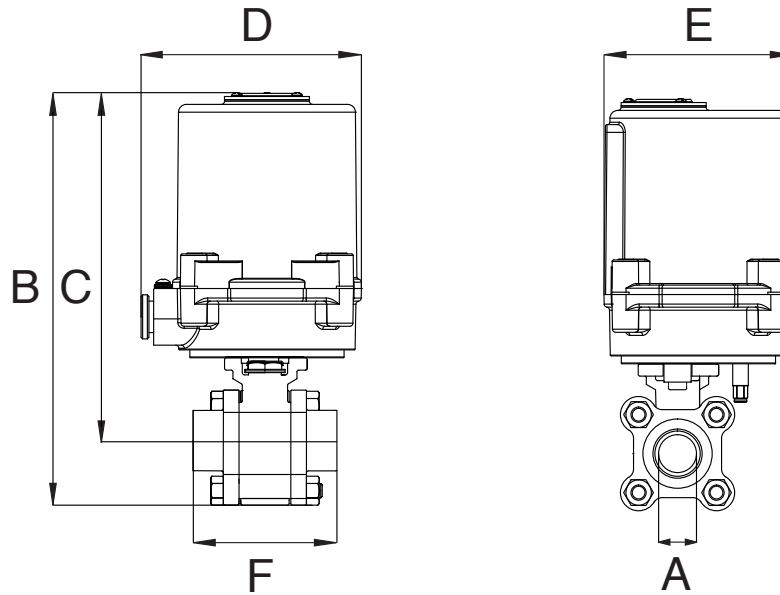

Size	A	B	C	D	E	F	ACT.
1/4"	0.25	9.24	8.42	5.51	4.43	2.62	EAX035
3/8"	0.38	9.24	8.42	5.51	4.43	2.62	EAX035
1/2"	0.50	8.88	8.03	5.51	4.43	2.76	EAX035
3/4"	0.75	9.16	8.22	5.51	4.43	3.62	EAX035
1"	1.00	9.50	8.46	5.51	4.43	4.14	EAX035

ON/OFF WIRING DIAGRAM

24V DC, 24V AC, 110V AC & 220VAC

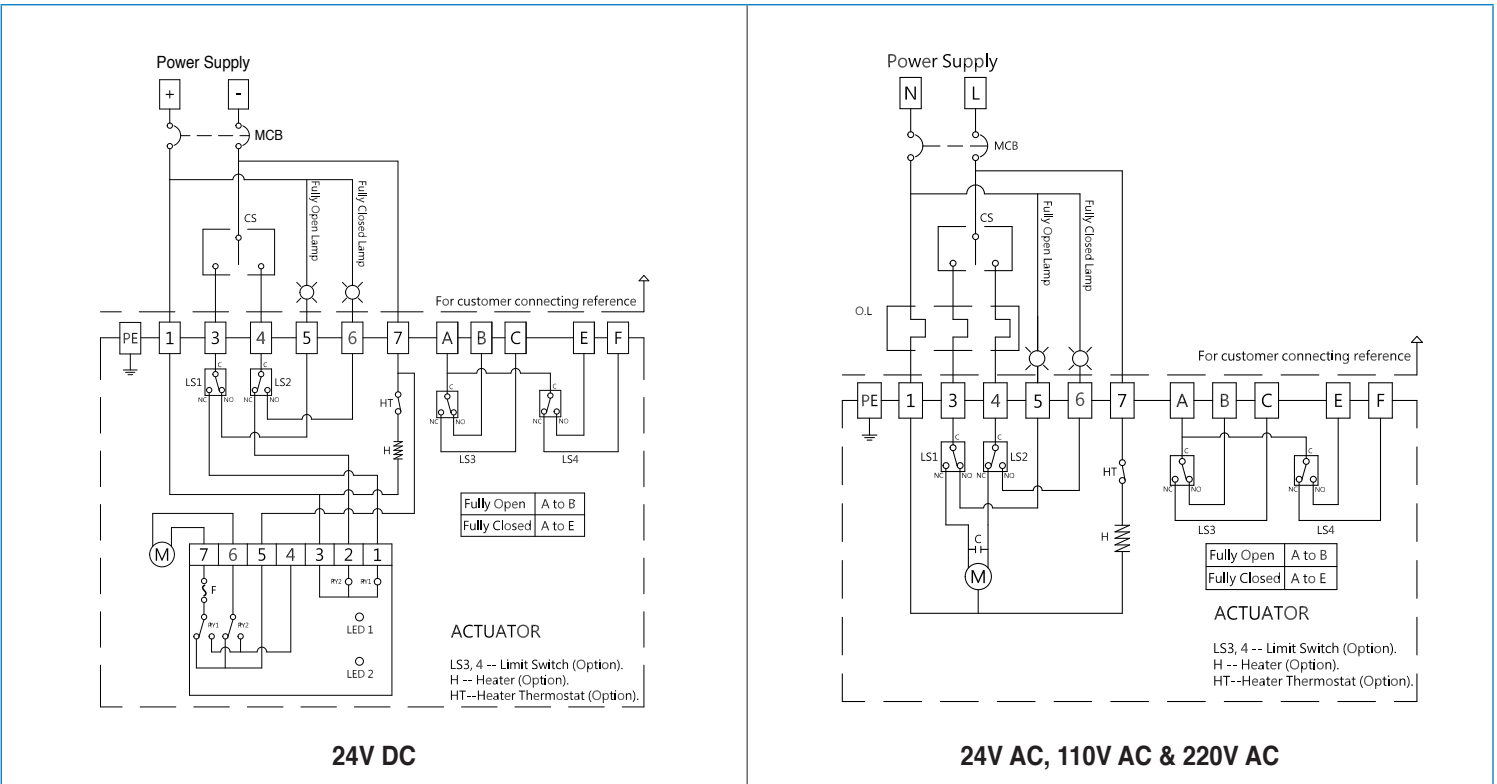

POSITIONER WIRING DIAGRAM

24V DC, 24V AC, 110V AC & 220VAC

